



23 Toronto Road, Gillingham, ME7 2EP

VIRTUAL TOUR AVAILABLE

GUIDE PRICE £230,000 - £240,000

This property could make the Ideal first time buyers home and is available to view now. The current vendors have done many updates to the property over the last four years and internal viewings are highly recommend.

As you step into the property you will find the entrance area offering access to the lounge and stairs to first floor. The lounge is a good size with laminate floors and minimalist decor. Stretching across the width of the property is modern kitchen diner with plenty cupboard space and built in appliances over looking a good sized rear garden. To the first floor there are two good sized bedrooms and family bathroom with separate shower. Additional benefits include gas central heating and double glazed windows.

Call us today to book your internal viewing

- 2 BEDROOMS
- FITTED KITCHEN/DINER
- LOUNGE
- BATHROOM
- COUNCIL TAX BAND B
- CENTRAL HEATING
- DOUBLE GLAZED WINDOWS
- EPC RATED D
- GUIDE PRICE £230,000 - £240,000

£230,000

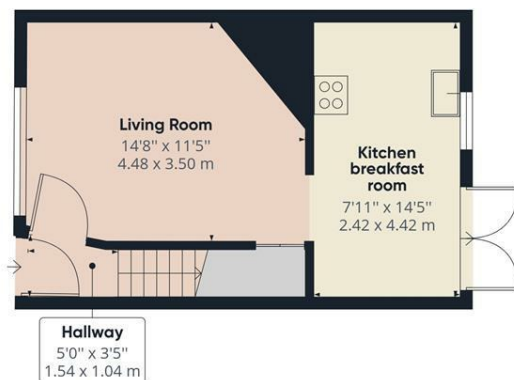

Ground Floor

Approximate total area⁽¹⁾

611.91 ft²
56.85 m²



Floor 1

(1) Excluding balconies and terraces

While every attempt has been made to ensure accuracy, all measurements are approximate, not to scale. This floor plan is for illustrative purposes only.

GIRAFFE360

